

D-Sub Connectors

Crimp contacts on REEL

Contacts:	Copper Alloy, Stamped & Formed Pins 100 inserts min.
Contact Plating:	Selective Gold over Nickel
Package:	REEL - 5.000pcs Loose / BULK
Crimp Tooling:	See page 154-155



Crimp Plug connector

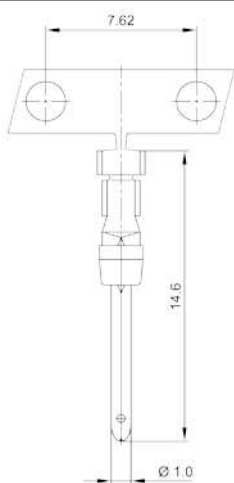

Crimp Socket connector

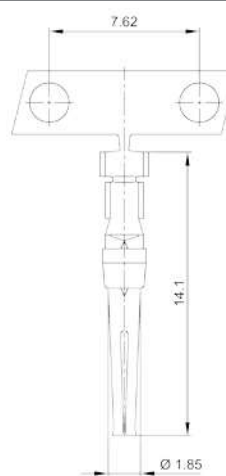

AWG 24-28 - LOOSE Crimp Contacts

Stamped & Formed Crimp Contacts - LOOSE CONTACT PINS

Type:	Size:	Part Number:	Description:
Male Contacts	AWG 24-28	2101-0198-01	DCT-MG2-100
Female Contacts	AWG 24-28	2101-0198-11	DCT-FG2-100

AWG 24-28 / 20-22 - Crimp Contacts on REEL

REEL - AWG 24-28
AWG 20-22

Volume: 5.000pcs
Direction: Right

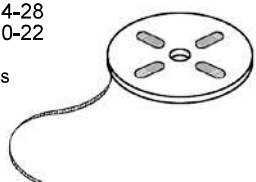

Stamped & Formed Crimp Contacts on REEL

Type:	Size:	Part Number:	Description:
Male Contacts	AWG 24-28	2101-0199-01	DCTM-G2
Male Contacts	AWG 20-22	2101-0199-02	DCTM-G1
Female Contacts	AWG 24-28	2101-0199-11	DCTF-G2
Female Contacts	AWG 20-22	2101-0199-12	DCTF-G1



Encitech Connectors AB
Rörkullsvägen 4
SE-302 41 HALMSTAD, Sweden

Tel: +46-(0)35-15 13 90
e-mail: connectors@encitech.com

www.encitech.com