

RoHS

THIS IS A RoHS
COMPLIANT
COMPONENT/
PRODUCT.

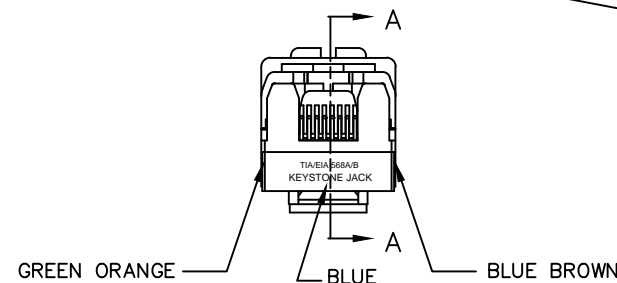
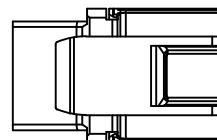
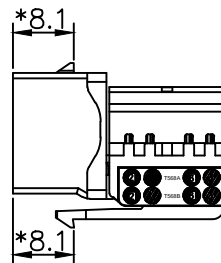
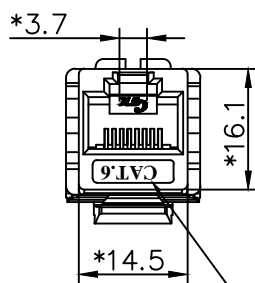
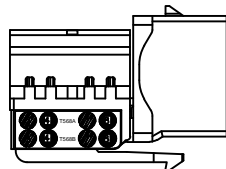
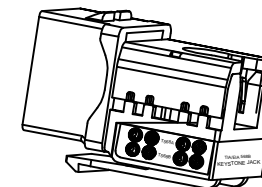
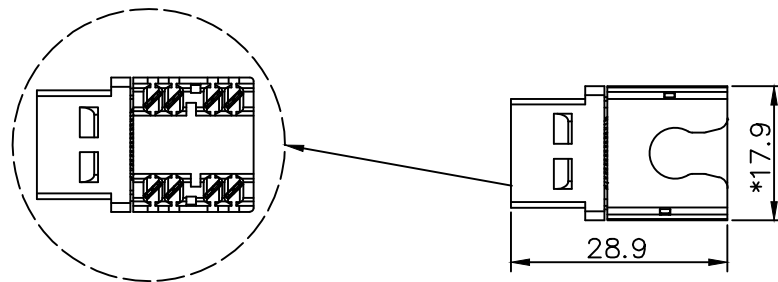

AREA: 7.4*1.8mm
FONT: Times New
Roman (bold)
LOGO ABOVE THE
SURFACE 0.25mm

NOTES:

ELECTRICAL:

- 1. VOLTAGE RATING : 125 VAC.
- 2. CURRENT RATING : 1.5 AMP.
- 3. CONTACT RESISTANCE : 100 MILLIOHMS MAX.
- 4. INSULATION RESISTANCE : 1000 MEGOHMS MIN. @ 500 VDC.
- 5. DIELECTRIC STRENGTH : 750 VAC 60Hz, 1MIN.

MECHANICAL:

- 1. HOUSING MATERIAL : PC UL94V-0
- 2. INSERT MATERIAL : PBT+30%GF-UL94V-0
- 3. PCB MATERIAL : FR-4 THICKNESS 1.6mm
- 4. CONTACT MATERIAL : PHOSPHOR BRONZE
STAMP PIN t=0.35mm
- 5. IDC CONTACT MATERIAL : PHOSPHOR BRONZE t=0.50mm
WITH NICKEL PLATING
- 6. WIRE : AWG 24~26

ENVIRONMENTAL:

- 1. STORAGE : -40°C TO +85°C.
- 2. OPERATION : 0°C TO 70°C.

CONFORM TO TIA/EIA 568 B.2-1
MATES WITH MODULAR PLUG CONFORMING
TO FCC PART 68, SUBPART F.

0069000		NEW DESIGN		EVA	031506
MARK	ECN-NO.	REVISION RECORD		DRAWN	DATE
		UNLESS OTHERWISE SPECIFIED TOLERANCE		SCALE	CHECKED
		Dimension Range Tolerance		1/1	Eva
		X.X	±0.20	UNIT	APPROVED
		X.XX	±0.15	mm	David
		X.XXX	±0.10	SIZE	A3
Material/Plated/Notes		NAME		KEYSTONE ,SIDE ENTRY C6	
SEE NOTE		PART NO.		326I-00I3-05	
Tooling No.		DOC. NO.		REV. A	